

Dwo Armii

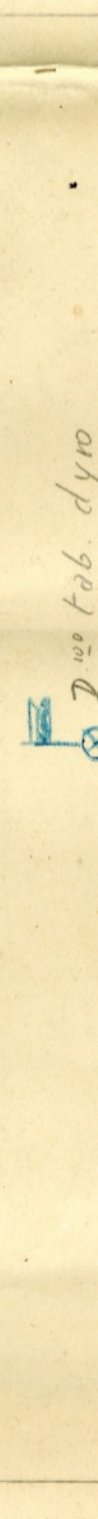

Dwo Armii

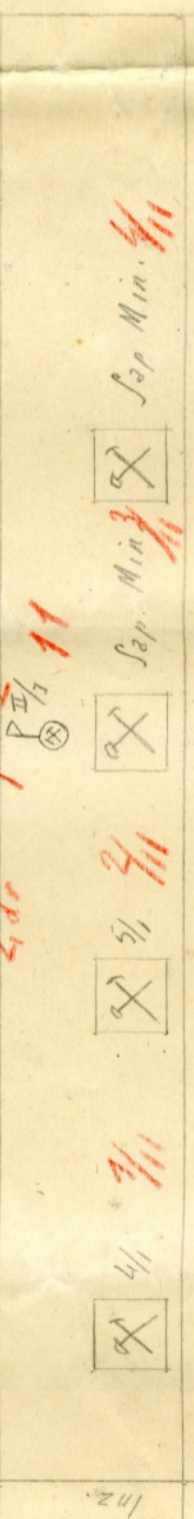
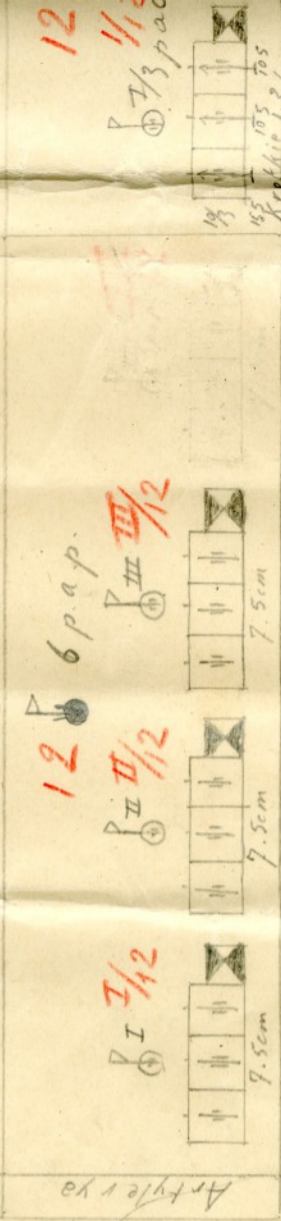
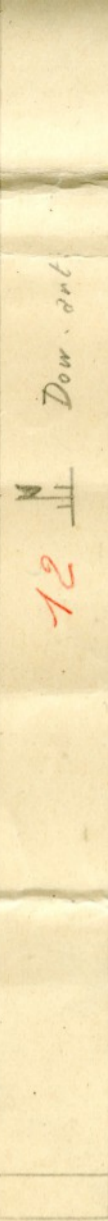
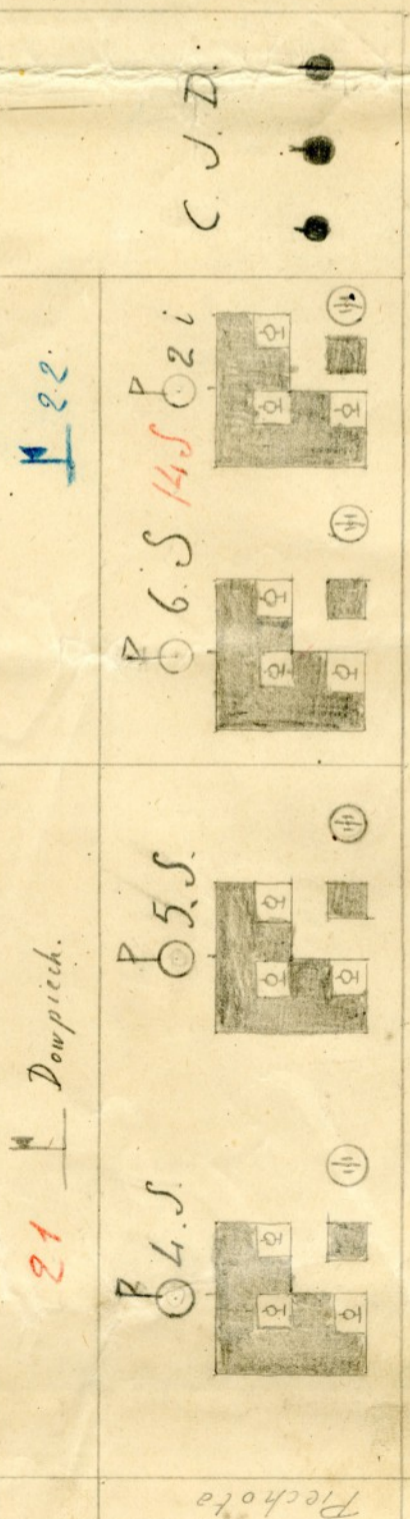
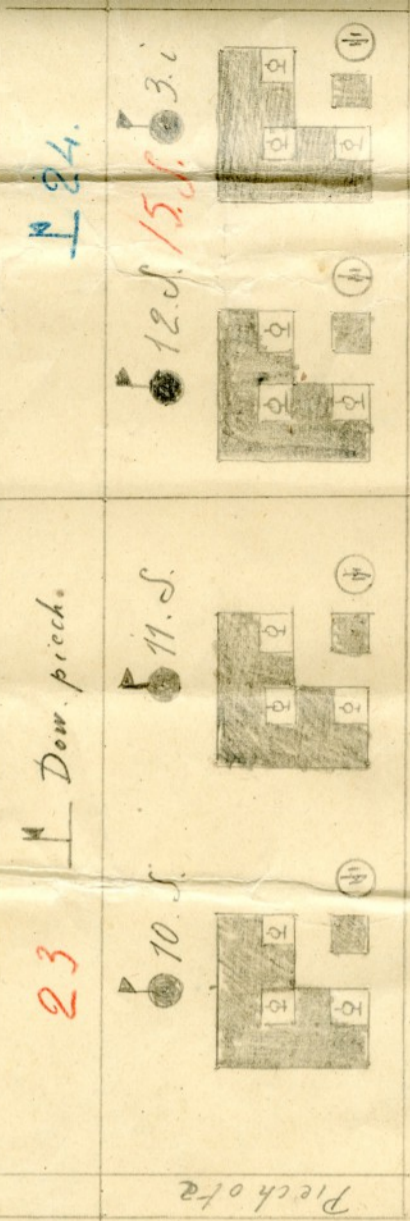
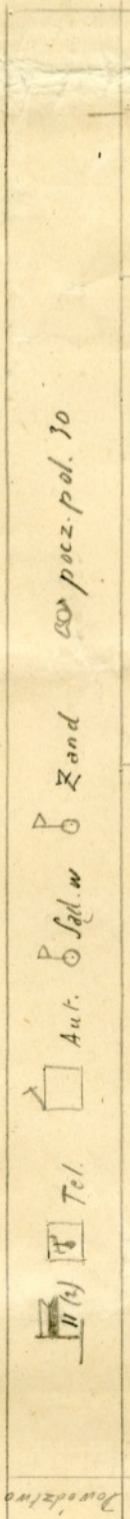
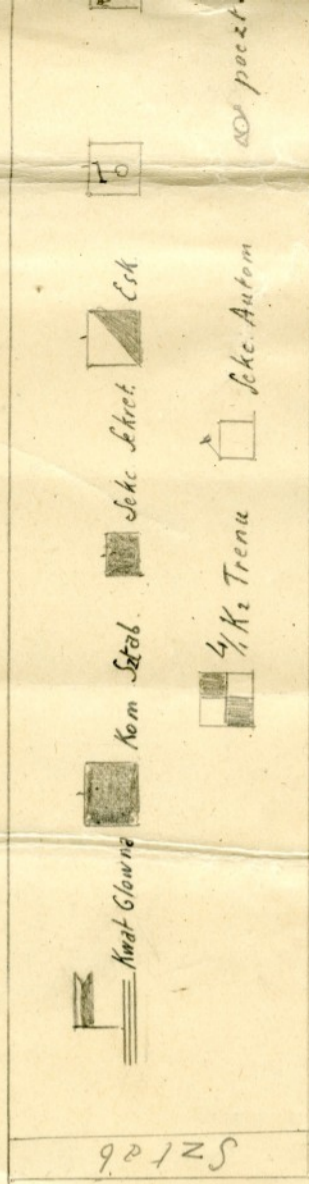
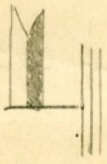

Dow. piech.				
		C. J. D		



D. no tab. dyro

Dow. piech.					
				C. J. D	



Dow. tab. dyro

1/2 4/3 3/12

D<sup>no</sup> tab. dyro. 12

+ Sanit.

21 SAP 21 SAP III 22 SAP 23 SAA 1.5 cm III 25 SAP III 105

Tab. Adm B Tr M P Korp

Szp. Kone 12

3/3 part. 12

Wst 6 12

1/4 4/3 2/4 3/13

D<sup>no</sup> tab. dyro. 13

+ Sanit.

D.P.A. 21 SAP I 22 SAP I 23 SAA I 7.5 25 SAA I 105

G. Adm B Tr M P Korp

Szp. Kone 13

3/1 part. 13

Wst 7 13

Powodlino

Tel. Ant. zand. Sqd. W. and p. pol. 33

Down. piece 15

19 S 20 S 21 S

C. J. D.

Piechota

Down. Art. 15

7 p.a.p. 15

15 p.a.c. II/80ac 3/15

Inz.

4/1

4/1

Sep. Min.

Sep. Min.

D<sup>100</sup> tab. dyro

+

+

Sanit.

+

D.P.A

21 AP

22 AP

23 JAA

26 JAA

G Adm.

Tab Adm.

T.M.

P.

1/2

zpit. Koni.

6/12 park.

Wrst. 2

Inz.

1/2

4/3

4/3

D<sup>100</sup> tab. dyro

+

+

Sanit.

D.P.A

21 AP

22 AP

23 JAA

26 JAA

G Adm.

Tab Adm.

T.M.

P.

1/2

zpit. Koni.

6/12 park.

Wrst. 6

Inz.

35. 14

35. 14

Sep. Min.

Sep. Min.

Dow. Piech. 14

7s.

8s.

9s.

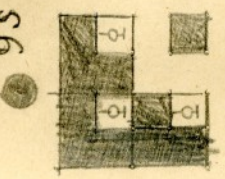
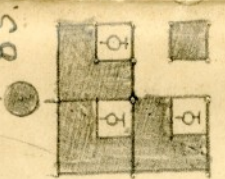
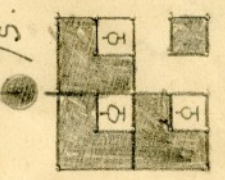

C.J.D.

Dow. Art. 14.

Inz.

3 p.a.p. 14

3 p.a.p. 14

Sep. Min.

Sep. Min.

Dow. Piech. 14

7s.

8s.

9s.

C.J.D.

Dow. Art. 14.

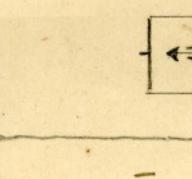
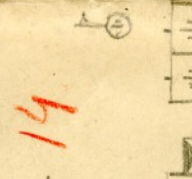
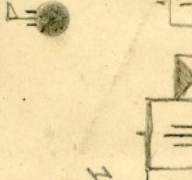

C.J.D.

Dow. Art. 14.

Dow. Art. 14.

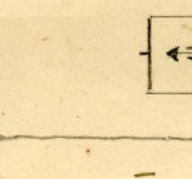
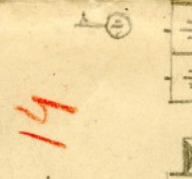
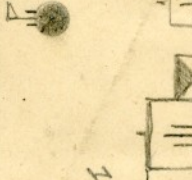

C.J.D.

Dow. Art. 14.

Dow. Art. 14.





Dzielnica Tel. Auto O Saneż W O Zand p pol. 34.

↓ Dow. piech.

↓ Dow. arch.

Ⓜ I

☐ <sup>5/6</sup> J. K.

Ⓜ

Ⓜ

☐ + amb.

☐ + sanit.

☐

☐

☐

☐

☐

☐ Park

Dow. prech.

Dow art.

I  
⊕

5. K.  
⊕

⊕

⊕

+ amb.

+ sanit.

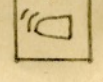
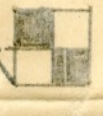
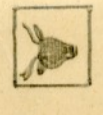

Perk.

Piechota

Artylerja

Jazda

Inz.

St. z dow.

mun.

Intend.



ODZTWA

5. D.S.  
na Syberyi

16.S.  17.S.  18.S.  St.

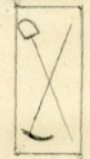
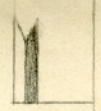

Do rozporządzenia M.S.W.

Głowa Instrukcyjna

4 sp. Spista of m...  
5 spk.  
asymmetrycznym  
niepłynnym  
podługowym  
kryształ  
baon szkolny

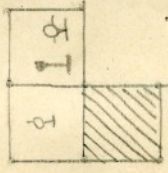

5/sp  
II 6/sp  
Spec.  
Szkolna

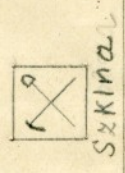

I II III IV V VI VII VIII

5 Ustawa Medycyna

5 7 6 7 8 9 10 11 12 13

kublin  
Siedlee

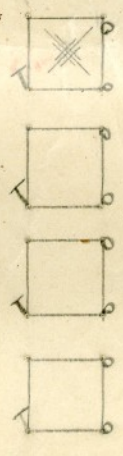

75 105 75 105  
SMS SMS  
75 105  
SMS SMS  
75 105

11, 12, 13. dyn.  
jako but  
zapras.

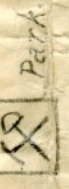

Przek



PERVA

# NACZELNEGO DOWODZTWA

Dotychczasowego

<p>1 Korpus</p> <p>8</p> <p>3/1</p> <p>9 Am. T.C.M. B. T.M. A"</p> <p>1 Korpus</p> <p>8</p> <p>Tabory</p> <p>2.13mm. Tab. 100m. B. T.M. A"</p>	<p>2 Korpus</p> <p>8</p> <p>Tabory</p> <p>2.13mm. Tab. 100m. B. T.M. A"</p>	<p>5. D.S. na Sybetyi</p> <p>16 S.</p> <p>17 S.</p> <p>18 S.</p>	<p>Artyleria.</p> <p>6 p.c.z.</p> <p>66</p> <p>580</p> <p>59</p> <p>521</p> <p>582</p> <p>102</p> <p>66</p>	<p>Kolejowe</p> <p>I PAK</p> <p>II PAK</p> <p>S.A.I.</p> <p>S.A.I.</p> <p>Wrsz. K1</p> <p>Wrsz. K3</p>	<p>Jazda</p>	<p>1</p>
--	---	--	---	--	--------------	----------

Uzup. Modlin

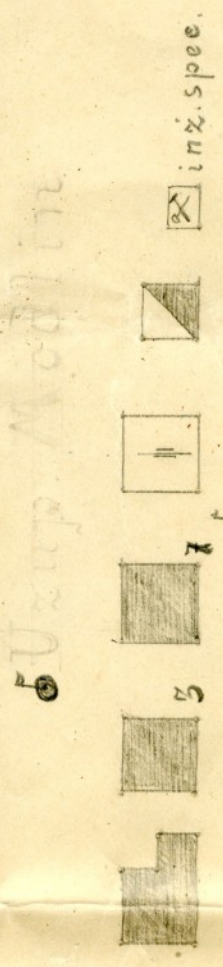

Lublin  
Siedlce

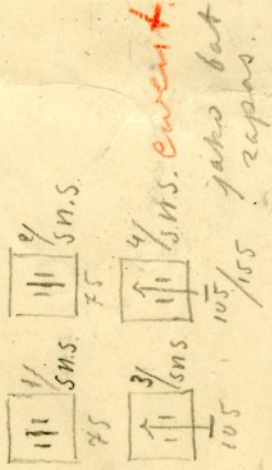
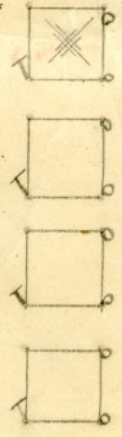

jako bat  
zapas  
11, 12, 13, dyn.

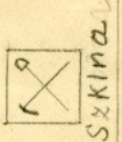
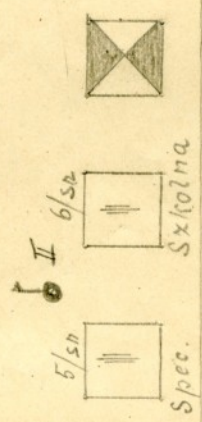
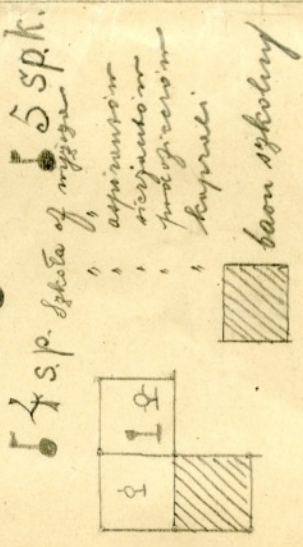

16s.  
17s  
18s  
19s

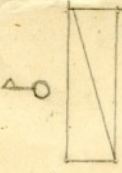
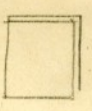







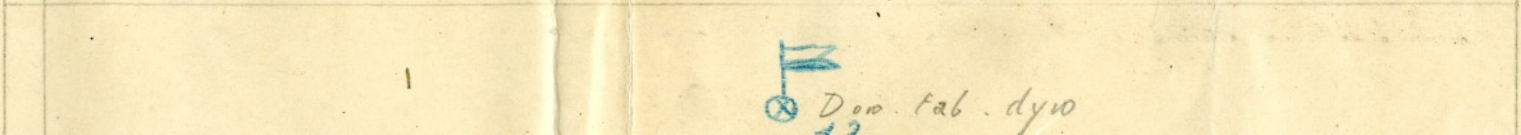
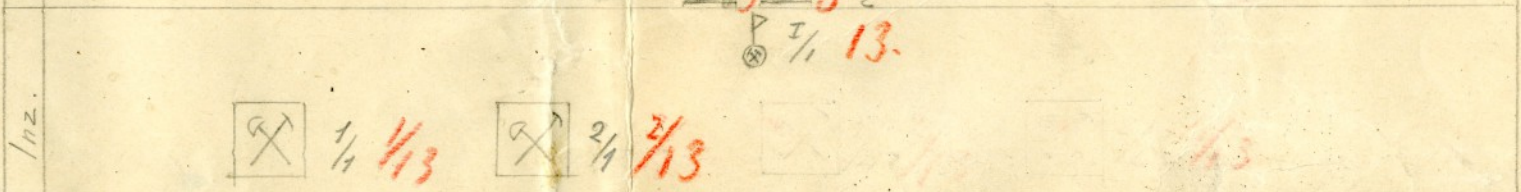
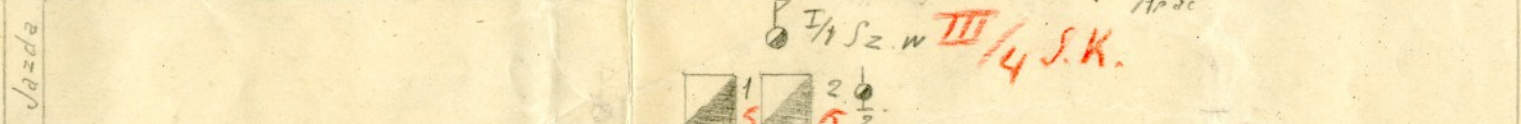
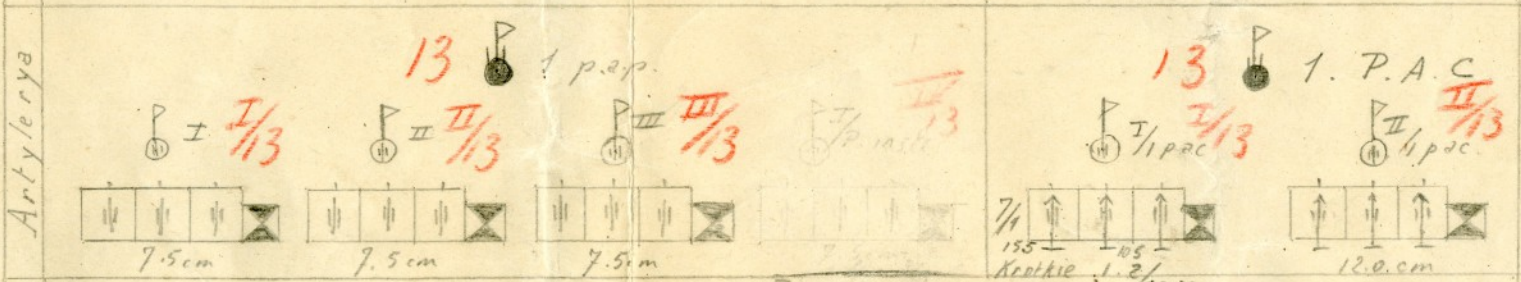
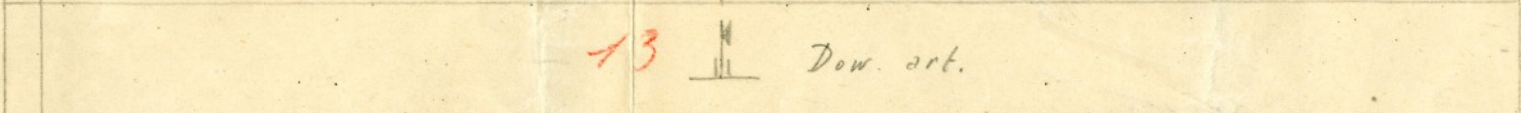
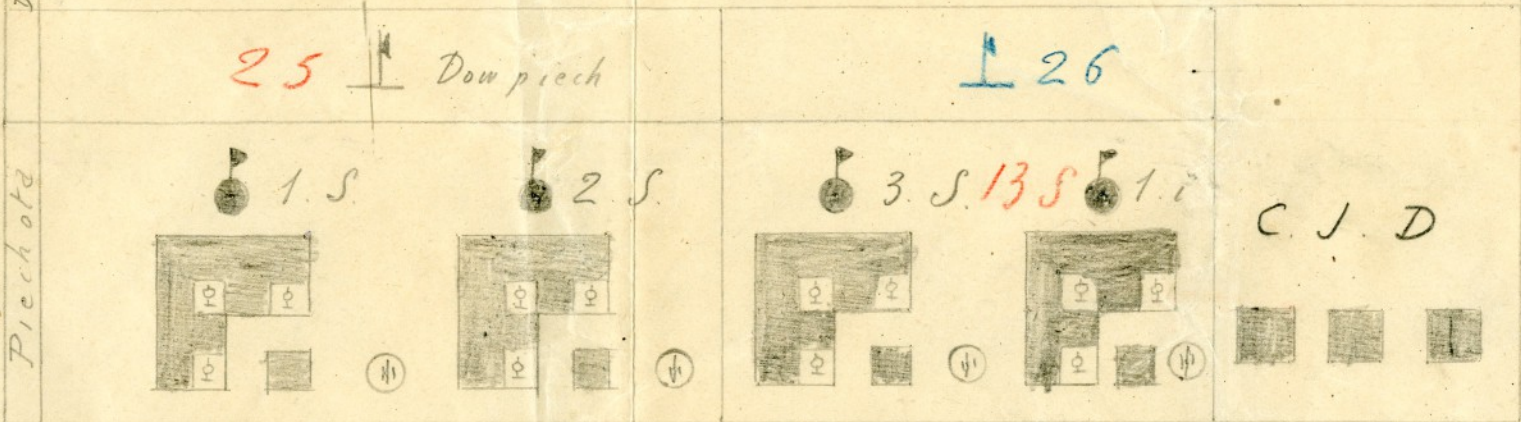
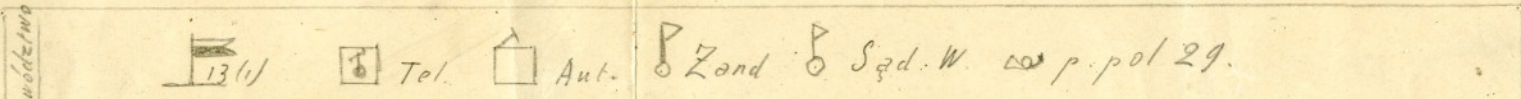
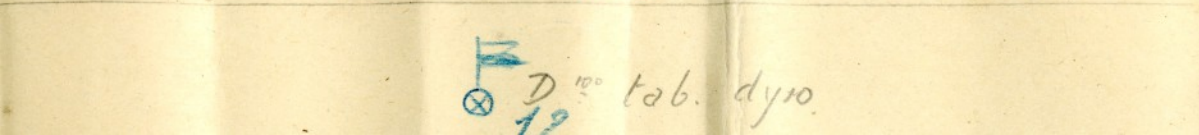
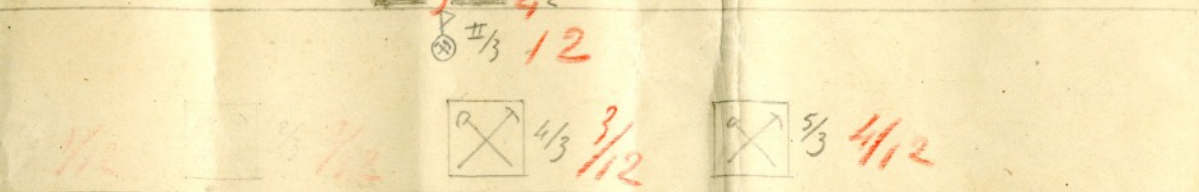
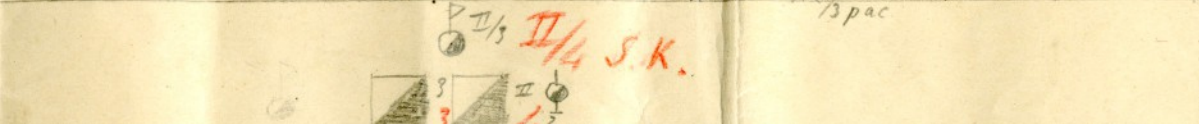
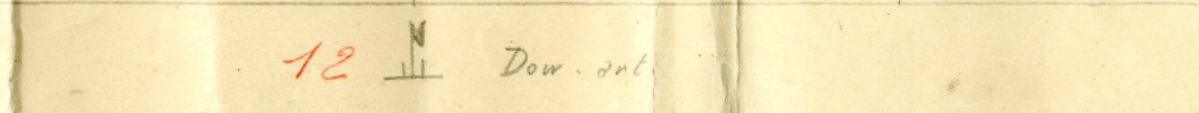
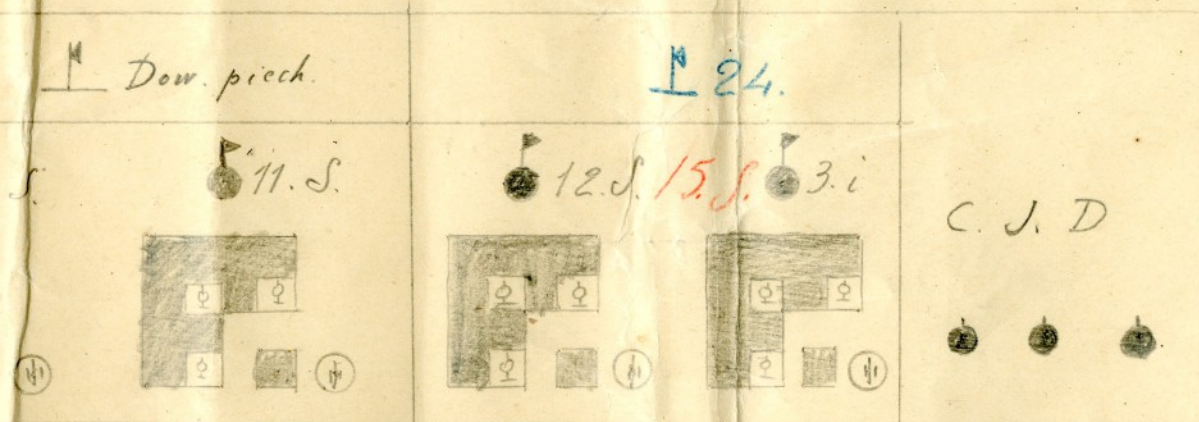
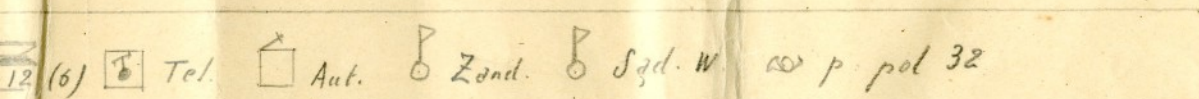
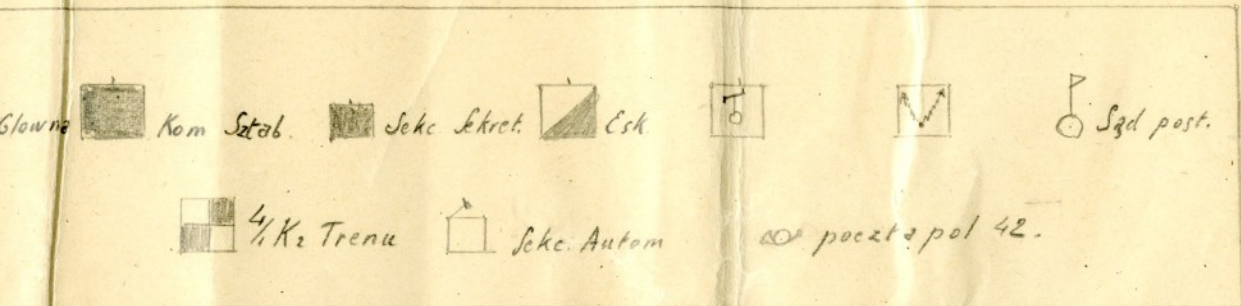

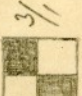
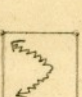
PILSUDSKI  
INSTITUTE  
ARCHIVES  
NEW YORK



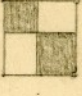



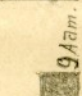
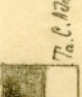
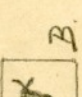
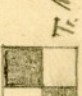
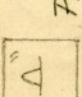
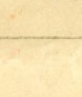
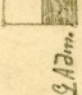
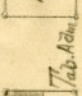
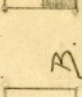

PILSUDSKI  
INSTITUTE  
ARCHIVES  
NEW YORK

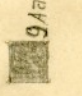
Dwo Armii



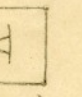

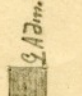
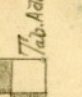
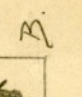



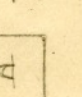
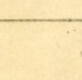



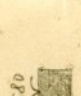

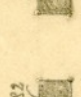





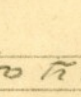











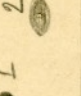



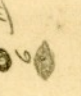











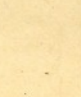













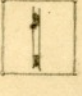







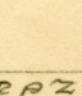









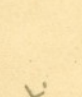
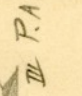

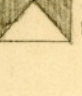
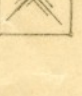
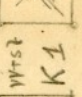
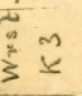



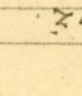









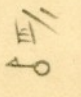
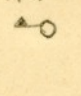

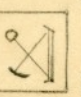
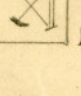
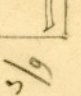
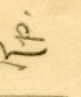
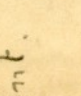



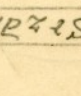







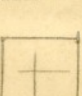
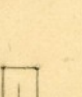
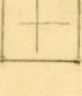

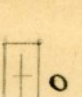





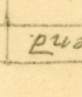









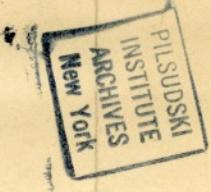





16 S.  17 S.  18 S.

Aviac. Czolgi. Kolejowe Jazda Inz. Szlakow. Inz. Amun. Inz. Amun.

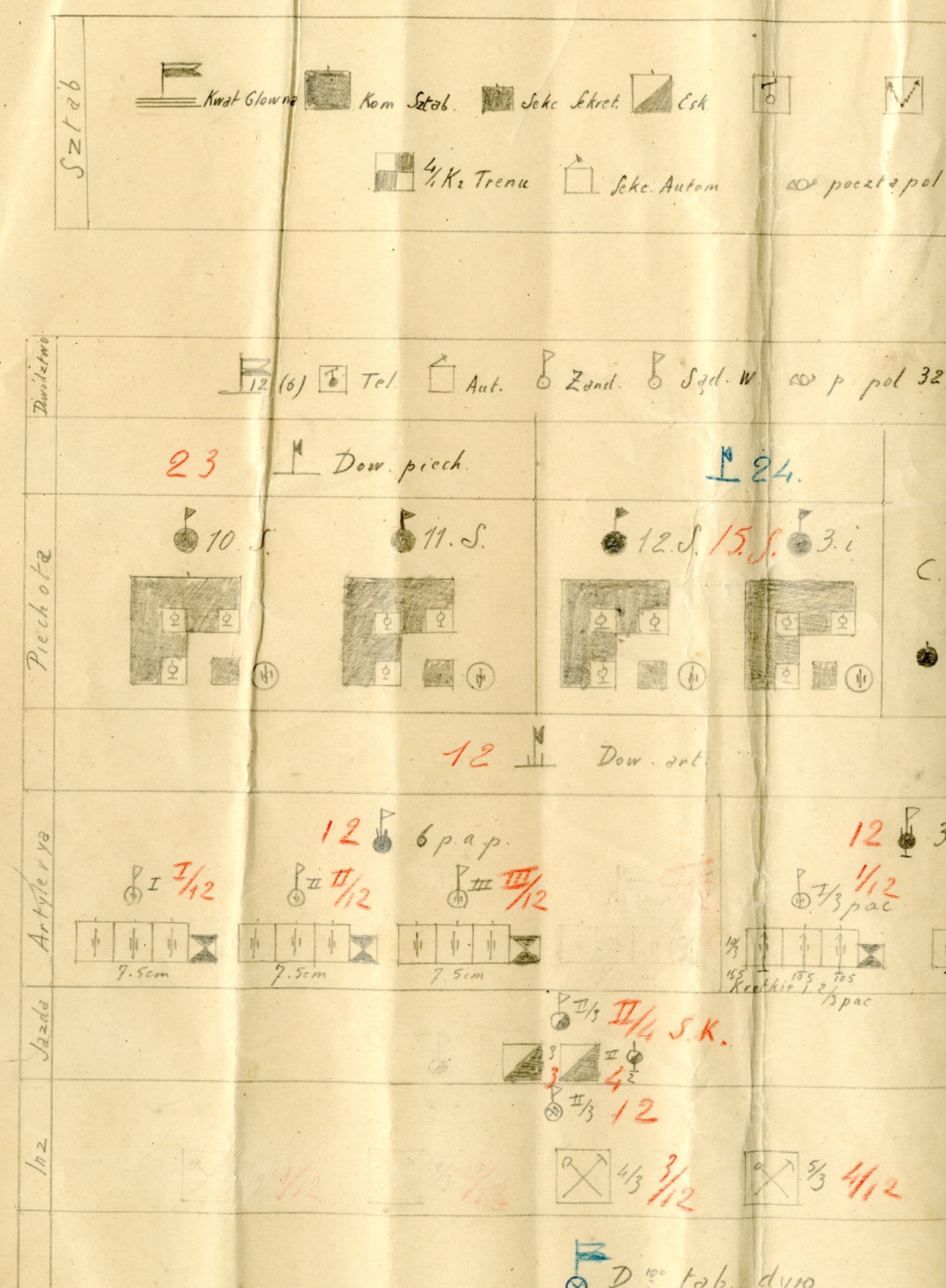
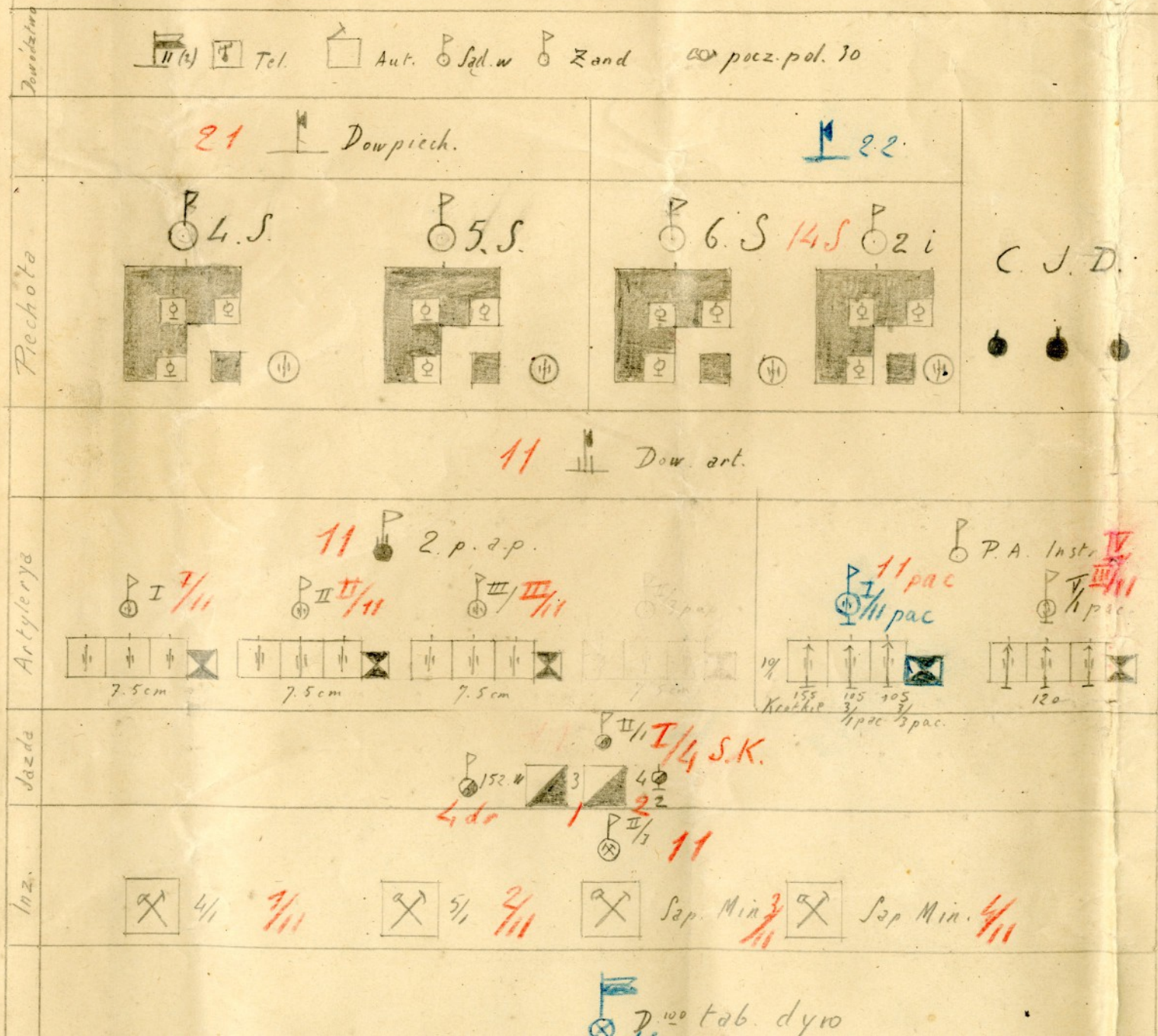

D100  Armii



1/3 1/2 1/3 1/2

D<sup>100</sup> tab. dyro  
12

+ Sanit.

SAP 21 SAP 22 SAP 23 SAA 25 SAA  
III 7.5 cm III 105

Tab. Adm B Tr. M P Kozp

Szp. Koni  
12

1/3 park.  
12

Wst 6.  
12

1/4 1/3 2/4 1/3

D<sup>100</sup> tab. dyro  
13

+ Sanit.

D.P.A 21 SAP 21 SAP 22 SAP 23 SAA 25 SAA  
I 7.5 I 105

G. Adm Tab. Adm B Tr. M P Kozp 111

Szp. Koni  
13

1/3 park.  
13

Wst 7  
13

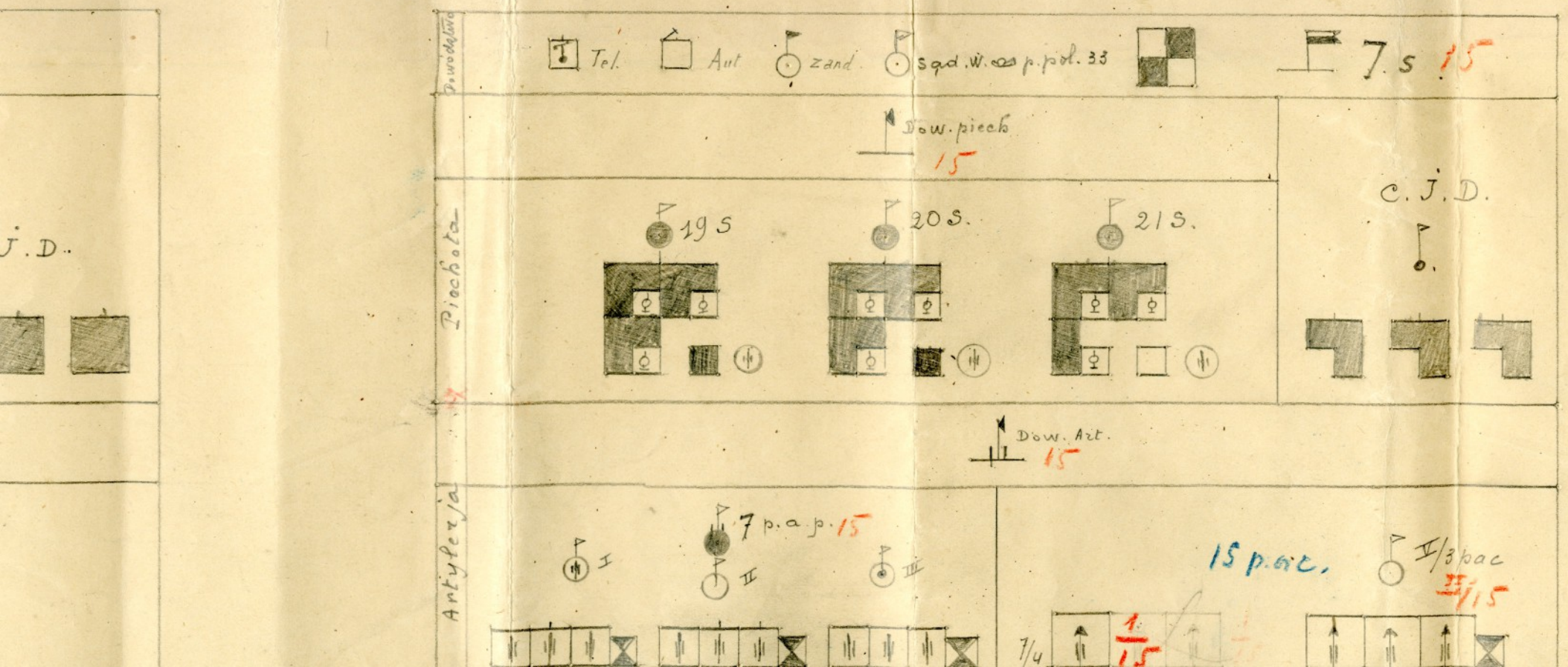

7<sup>100</sup> tab. dyro  
11

St. zdrow

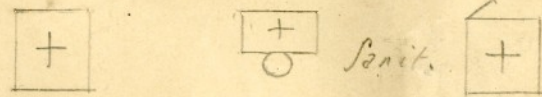

Amun.

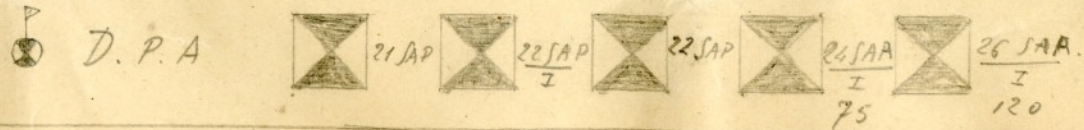

Intendent

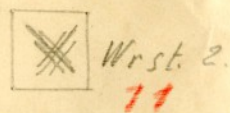
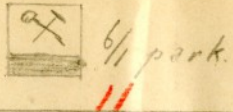
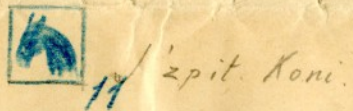

12<sup>100</sup> tab. dyro  
12

St. zdrow

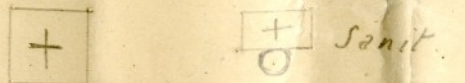

Amun.

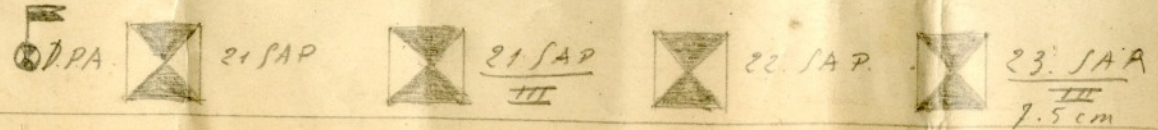

Intendent

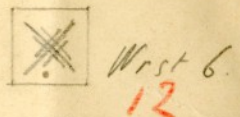
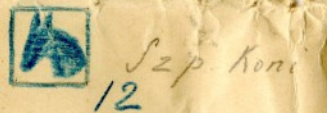
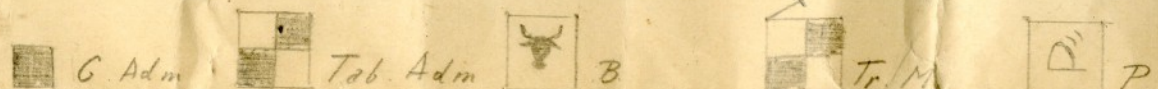

14

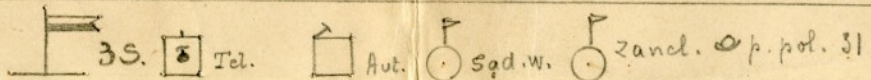

Piechota

Dow. Piech. 14

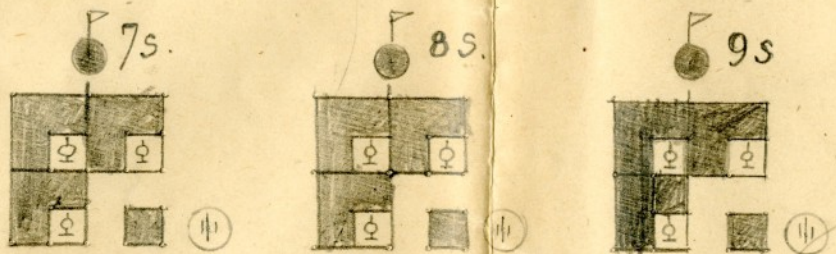

C.J.D.

Dow. Art. 14

Antylerja

3 p. a p. 14

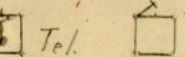
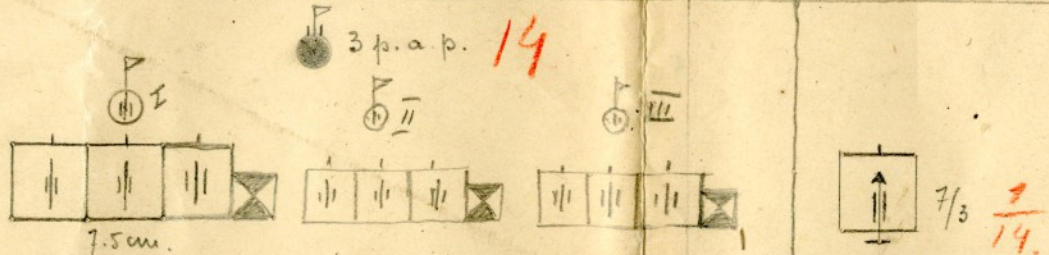

Piechota

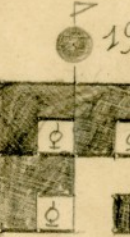

Antylerja

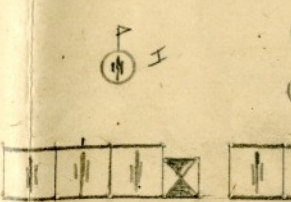



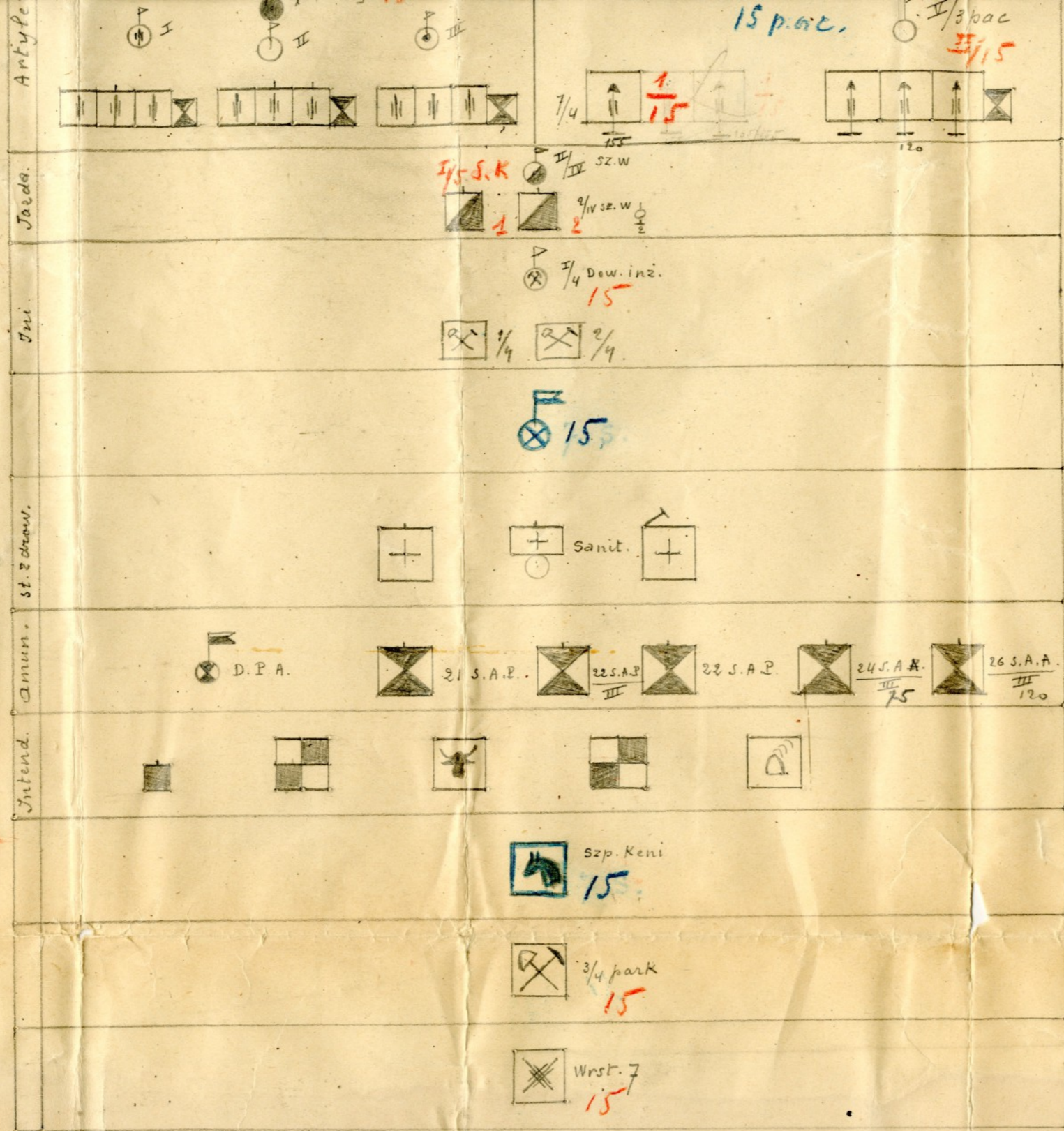



15 p. ac. I/30 ac  
III/15

Koop.

110

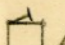
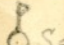
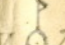
 Dinstn  Tel.  Auto  Sanit  Zand p pol. 34.

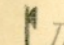
 Dow. piech.

Orly 2e	
Jarda	
Jni.	
St. zdrowia.	
Amun.	
Intend.	

Antylo	
Jarda	
Jni.	
St. zdrowia.	
Amun.	
Intend.	

Dinstn. Tel. Auto Szp. W. Zand p. pol. 34.  
 Dow. piech.

Dow art.

♁ I

☐ <sup>5/6</sup> S.K.

♁

♁

☐ + amb.

☐ + sanit

☐

☐

☐

☐

☐

☐ Park.

ODZTWA

Porozumienia M. S. W.

				Dow art.
Artylerija				
Jazda			J.K.	
Inz.				
St. zdrow.			amb.	sanit.
mun.				
Intend.				
			Park	

Do rozporządzenia

# NACZELNEGO DOWODZTWA

No



5. D.S.  
na Syberyi

16 S.

17 S.

18 S.

Sz.

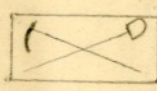
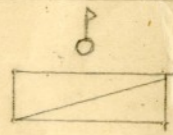
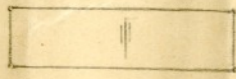

PILSUDSKI  
INSTITUTE  
ARCHIVES  
New York

# Gpa. Instrukcyjna

4 sp. Szkoła of muzyka 5 spk.

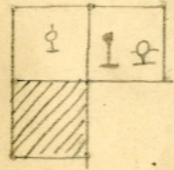

aspirantów  
podchorążych  
kaprali

baon szkolny

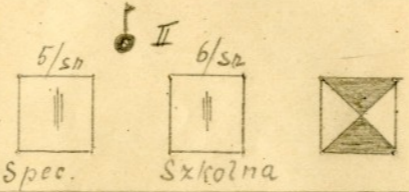

Spec. Szkolna

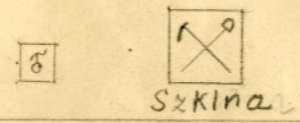

Szkolna

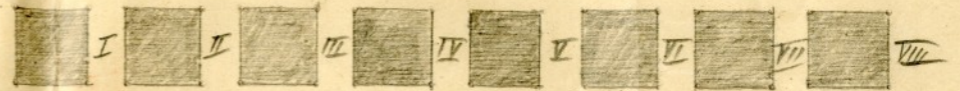

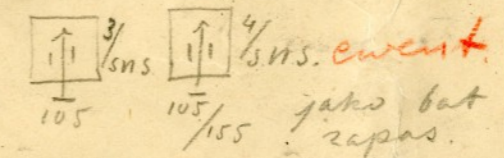
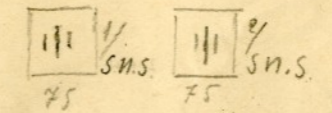
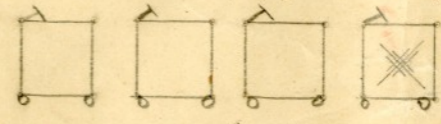
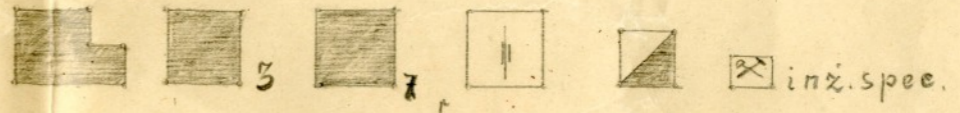

Uzup. Modlin



jako bat  
zapas.  
11, 12, 13, dyw.

PILSUDSKI  
INSTITUTE  
ARCHIVES  
New York

  
1 Korpus

  
3 Korpus

  
5. D.S.  
na Syberyi

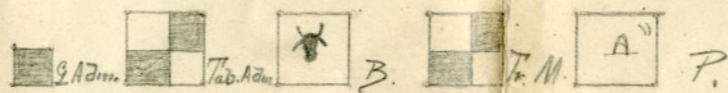
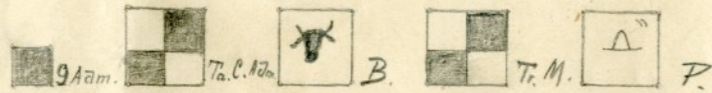
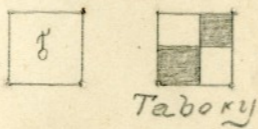
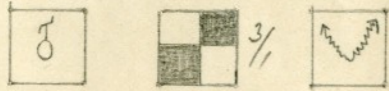

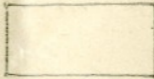
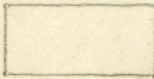
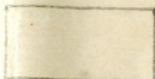
 16 S.  17 S.  18 S.

Awiac.

D. W. L.



Czołgi

p. c. z.



Kolejowe

Komp. Kolejowa

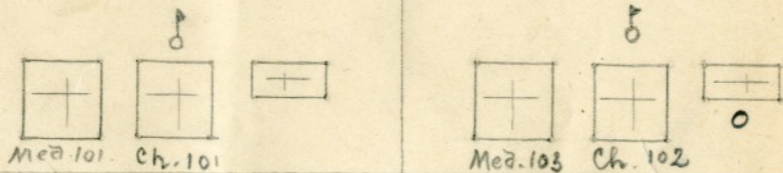
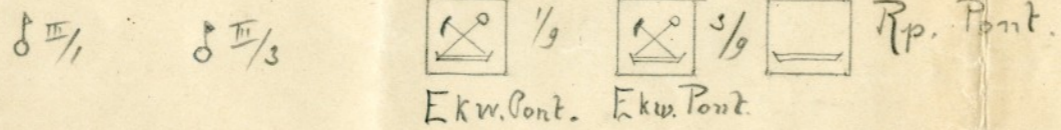
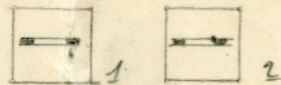

Plechnoza Dwostronno  
Kawaleria  
Pazza  
Inz.  
Szp. Sz.  
Amun.  
Inzyn.

